



1 Purr Wood

Godmersham, CT4 7DX

Offers In Excess Of £385,000

Spacious semi detached house with large garden, driveway and garage, in a delightful rural location with far reaching views over farmland to the rear.

Planning Permission exists for a two storey extension providing further bedroom and en suite and even more ground floor accommodation - Ref: 06/004P8/AS.

The house was traditionally constructed in the 1950's and has solid oak flooring and some original pine flooring. The accommodation comprises dining room, sitting room, conservatory, kitchen, two first floor double bedrooms, bathroom, attic playroom and hobby room.

- SPACIOUS SEMI DETACHED HOUSE
- LARGE GARDEN ENJOYING VIEWS OVER FARMLAND
- TWO DOUBLE BEDROOMS
- RURAL LOCATION
- PLANNING PERMISSION FOR TWO STOREY EXTENSION

Viewing

Please contact our Ashford Office on 01233 646411 if you wish to arrange a viewing appointment for this property or require further information.



2



1



2



E

Floor Plan

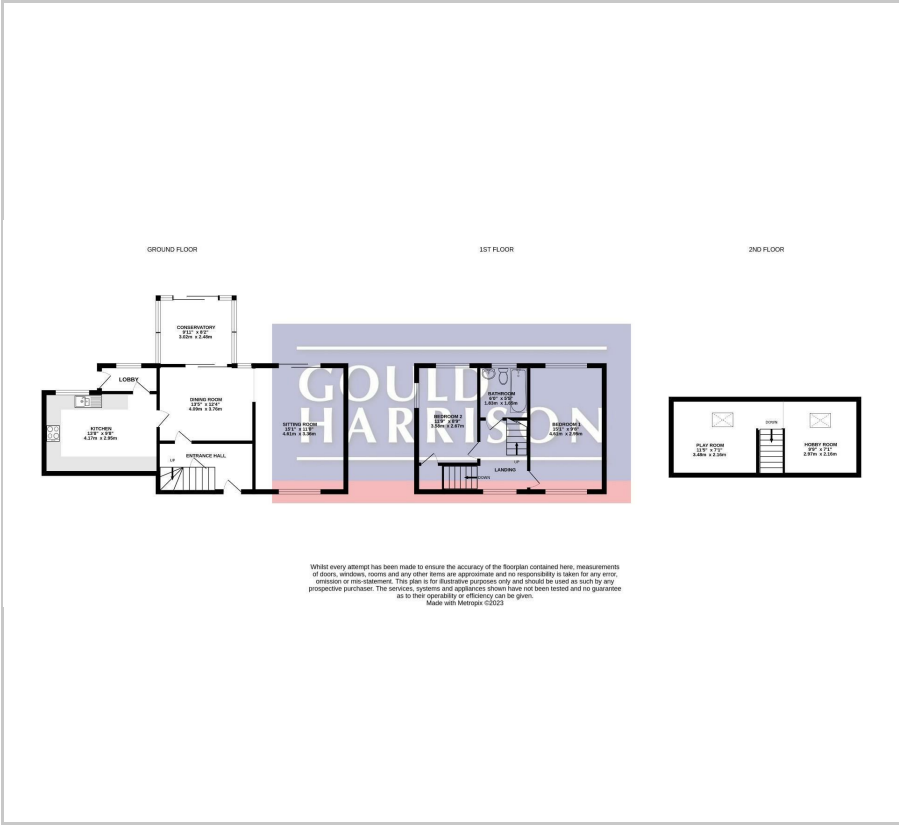

Area Map



Energy Efficiency Graph

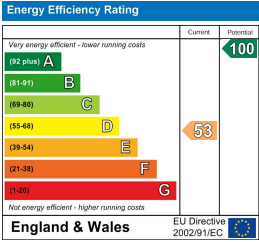

These particulars, whilst believed to be accurate are set out as a general outline only for guidance and do not constitute any part of an offer or contract. Intending purchasers should not rely on them as statements of representation of fact, but must satisfy themselves by inspection or otherwise as to their accuracy. No person in this firms employment has the authority to make or give any representation or warranty in respect of the property.